

PART NAME: PLAN VIEW

SHEET 2 OF 2
DRAWN BY:

DWG.#:

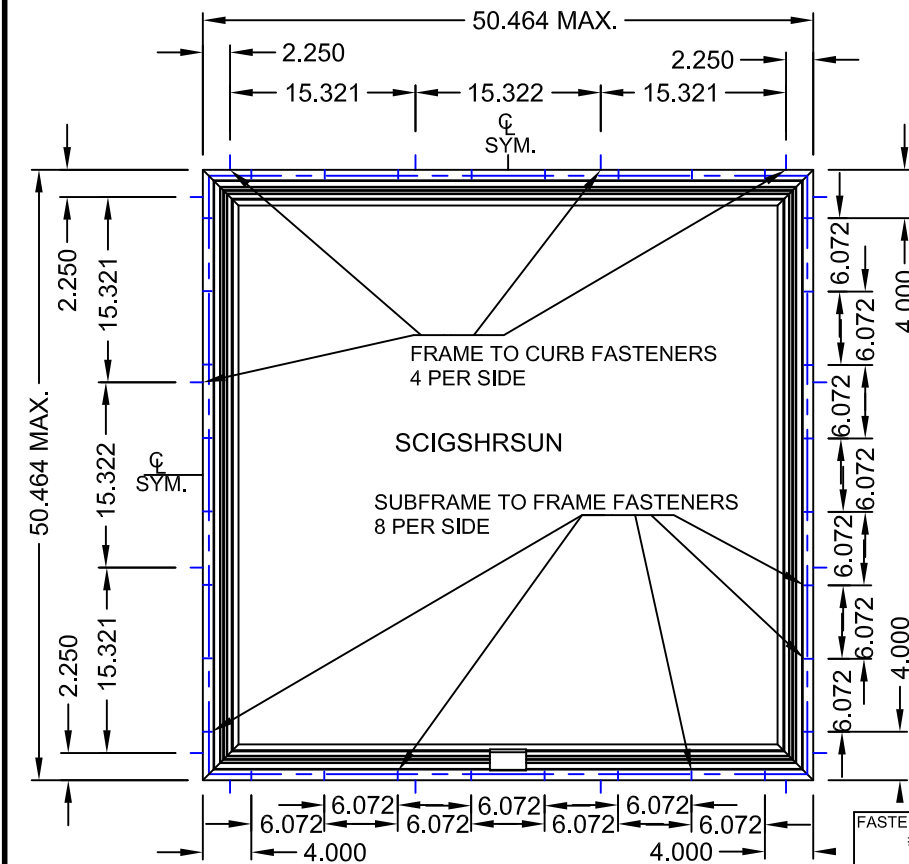

DESIGN PRESSURE RATING
+- 60 PSF.
LARGE MISSILE IMPACT RESISTANCE

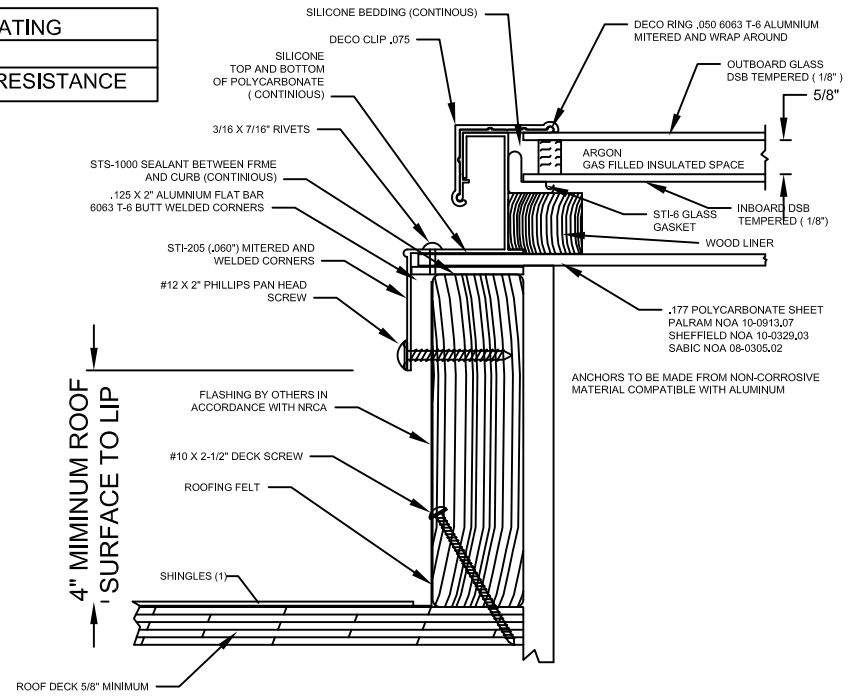

NOTE:

- * (1) ALL ROOFING DETAILS SHALL COMPLY WITH CHAPTER 15 OF THE FLORIDA BUILDING CODE
- (2) 4" MINIMUM DISTANCE FROM ANGLE LIP TO ROOF SURFACE IS FOR SHINGLE. OR B.U.R. WITHOUT INSULATION. FOR INSULATION AND TILE ROOF ADD TILE HEIGHT AND INSULATION THICKNESS TO 4" MINIMUM HEIGHT.
- (3) NO ONE-THIRD INCREASE IN THE DESIGN WAS USED.
- (4) ANCHOR TO BE MADE OF NON-CORROSIVE MATERIAL COMPATIBLE WITH ALUMINUM.

MODEL	FASTENER SCHEDULE SKYLIGHT TO CURB #12 X 2" PHILLIPS PAN HEAD SCREWS		FASTENER SCHEDULE CURB TO DECK #10 X 2-1/2" DECK SCREWS		FASTENER SCHEDULE SUB FRAME TO FRAME 3/16 X 7/16" RIVETS	
	PER LONG SIDE	PER SHORT SIDE	PER LONG SIDE	PER SHORT SIDE	LONG SIDE	PER SHORT SIDE
4949	4	4	5	5	8	8
4646	4	4	5	5	8	8
3349	4	3	5	3	8	6
3333	3	3	3	3	6	6
3046	4	3	4	3	8	5
3030	3	3	3	3	5	5
2549	4	3	4	3	8	5
2533	3	3	3	3	6	5
2525	3	3	3	3	5	5
2246	4	3	4	3	8	4
2230	3	3	3	3	5	4
2222	3	3	3	3	4	4
1749	4	2	4	2	8	3
1733	3	2	3	2	6	3
1446	4	2	4	2	8	3
1430	3	2	3	2	5	3

REVISION:	REVISION:	PRODUCT NAME: SCI -GSHRSUN	
INI:	DATE:	INI:	DATE:
DATE:		SCALE:	DWG No.